

# Renka RS20 sliding door – 3 track threshold detail

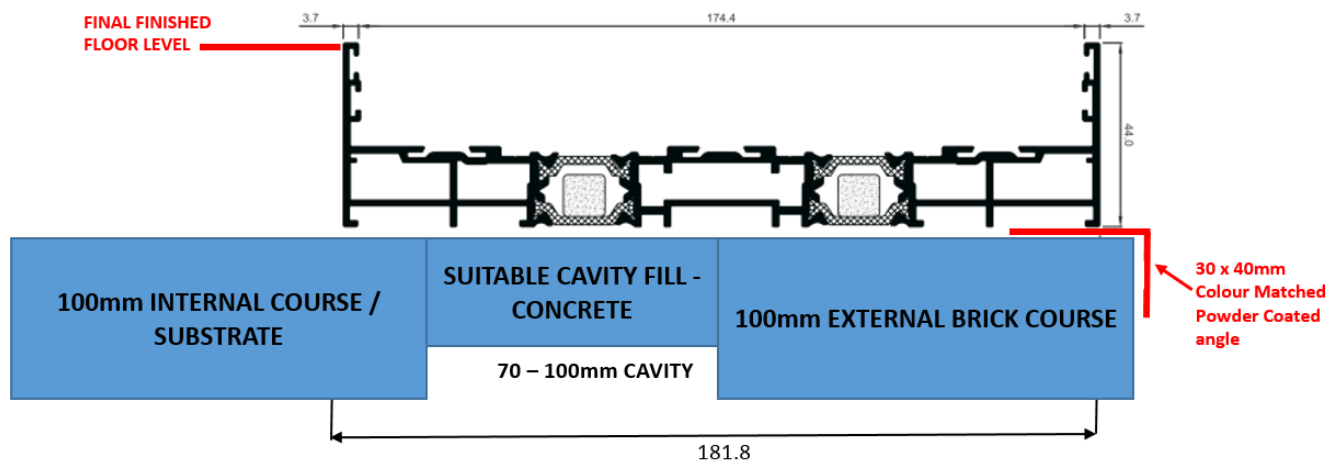

Client / contractor is responsible for installing DPC where necessary

## Title:

Renka RS20 Door Detail  
– COR4391

Please contact Renka, your  
architect or contractor should you  
require further advice

## Revision Date :

25.06.2018

The drawing is produced and distributed  
for the sole use of Renka Ltd and its  
clients and shall not be copied or  
otherwise reproduced without the  
consent and prior written permission of  
the company.



architectural glazing

sales@renka.co.uk  
www.renka.co.uk  
0121 333 4665